

Space Program is an established architectural practice specialising in residential design. Over the past 7 years, we have helped many people improve their homes and how they live in them. Throughout this process, we have experienced firsthand the importance of maximising usable space including creating clever storage solutions.

Our made-to-measure plywood furniture embodies this design knowledge. Developed to fit into an alcove, its modern Scandi-style reflects the same rigor and sensibilities as applied to our architecture.

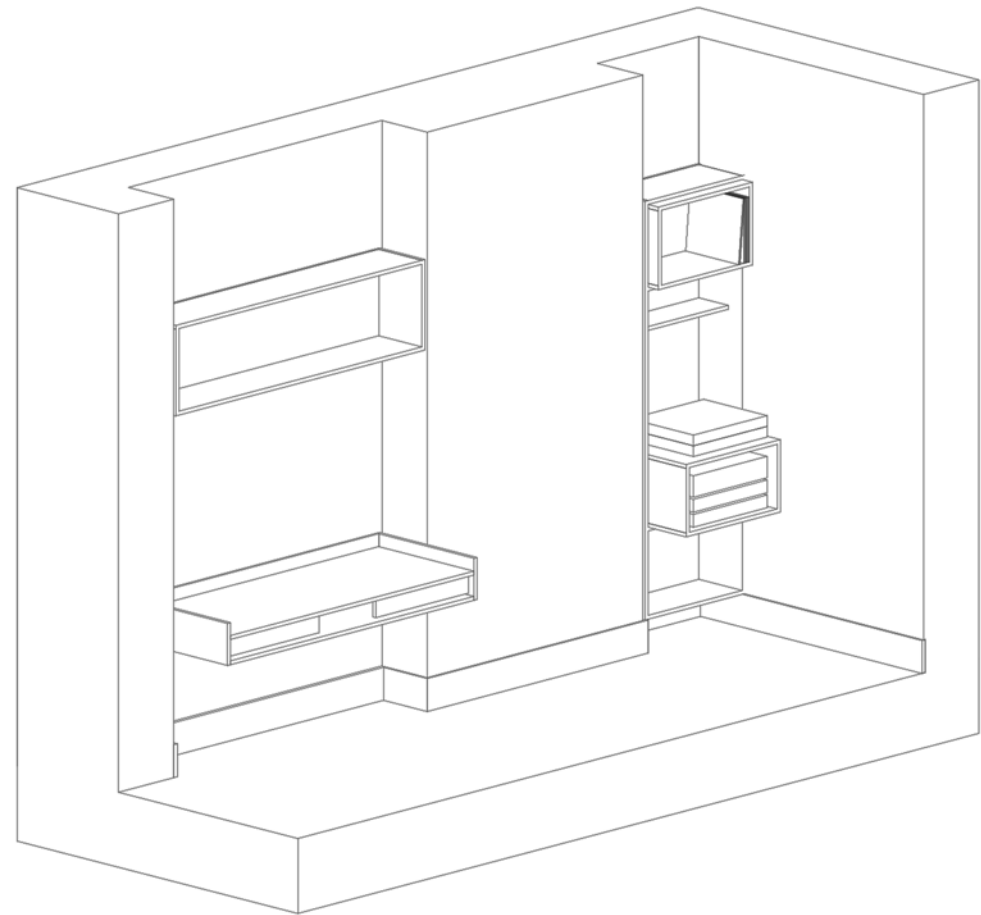

## 01 Shelf Box

£200 - £300

A classic wall hung plywood shelving box - clean and simple!

**Dimensions:**

Height: 43cm

Width: 100cm - 240cm

Depth: 25cm

**Material:**

Birch or Oak Veneer Plywood

**Finish:**

Satin water-based varnish as standard or Osmo Hardwax Oil

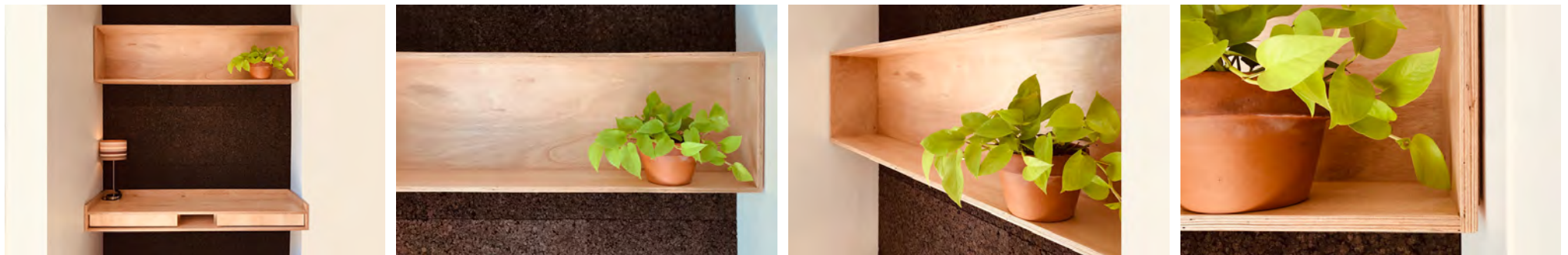
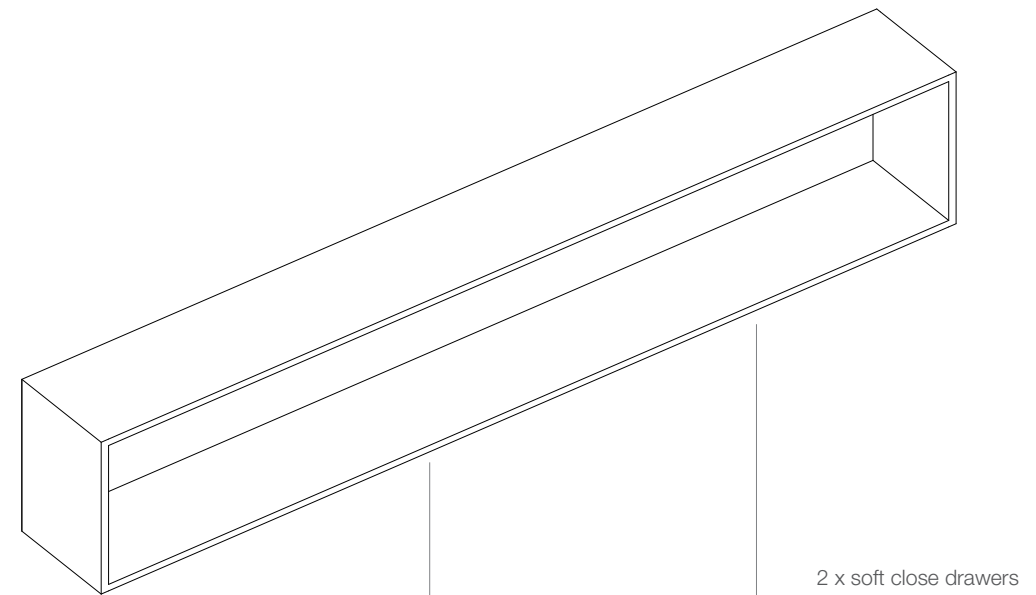

### 02 Desk Box

£750 - £1200

An elegant plywood desk for any home office, bedroom or living space. Designed to fit into an alcove, Desk Box is customised to your requirements. It comes with two soft close drawers and cable management holes.

**Dimensions:**

Height: 15cm  
Width: 100cm - 200cm  
Depth: 50 - 60cm

**Material:**

Birch or Oak Veneer Plywood

**Finish:**

Satin water-based varnish as standard or Osmo Hardwax Oil

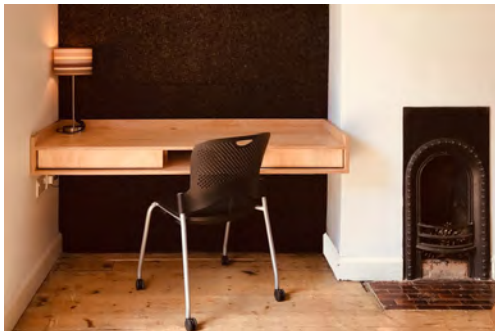
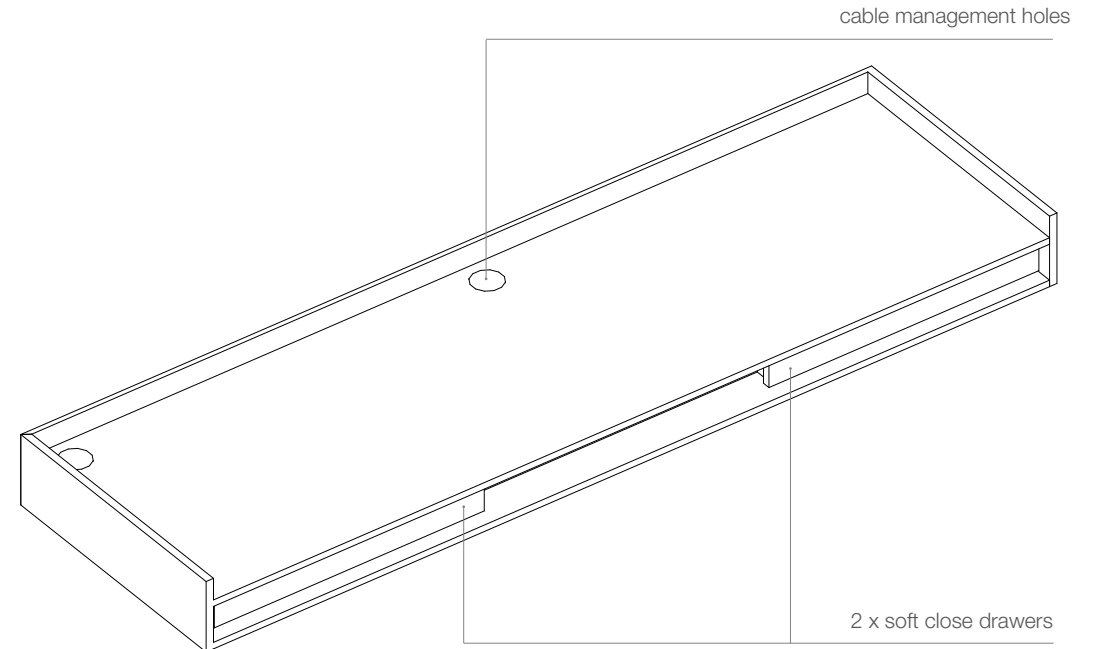

## 03 Deck Box

£600 - £900

Designed to fit vinyl, CDs and a record player, this elegant unit includes cable management holes and the option for one or two record storage shelves.

**Dimensions:**

Height: 190 - 240cm

Width: 55cm - 80cm

Depth: 50cm max (record player shelf)

**Material:**

Birch or Oak Veneer Plywood

**Finish:**

Satin water-based varnish as standard or Osmo Hardwax Oil

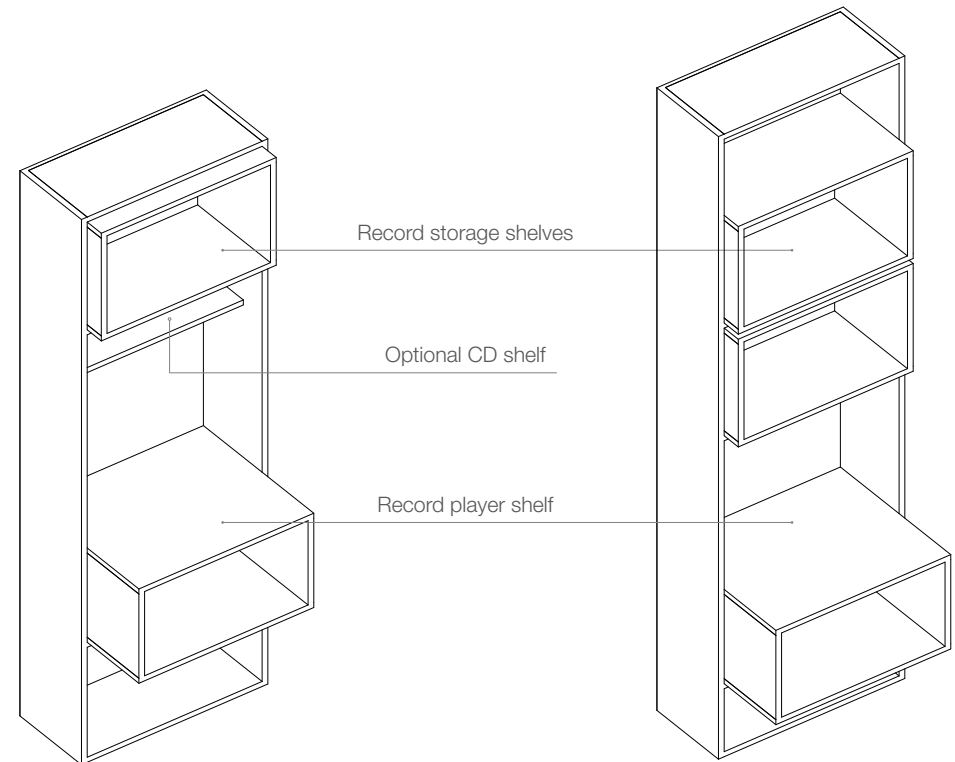



### 04 Media Box

£800 - £1600

A stylish media unit with book shelving above. It comes with cable management holes and additional DVD shelf on request.

**Dimensions:**

Height: 190 - 240cm

Width: 80cm - 200cm

Depth: 45cm

**Material:**

Birch or Oak Veneer Plywood

**Finish:**

Satin water-based varnish as standard or Osmo Hardwax Oil

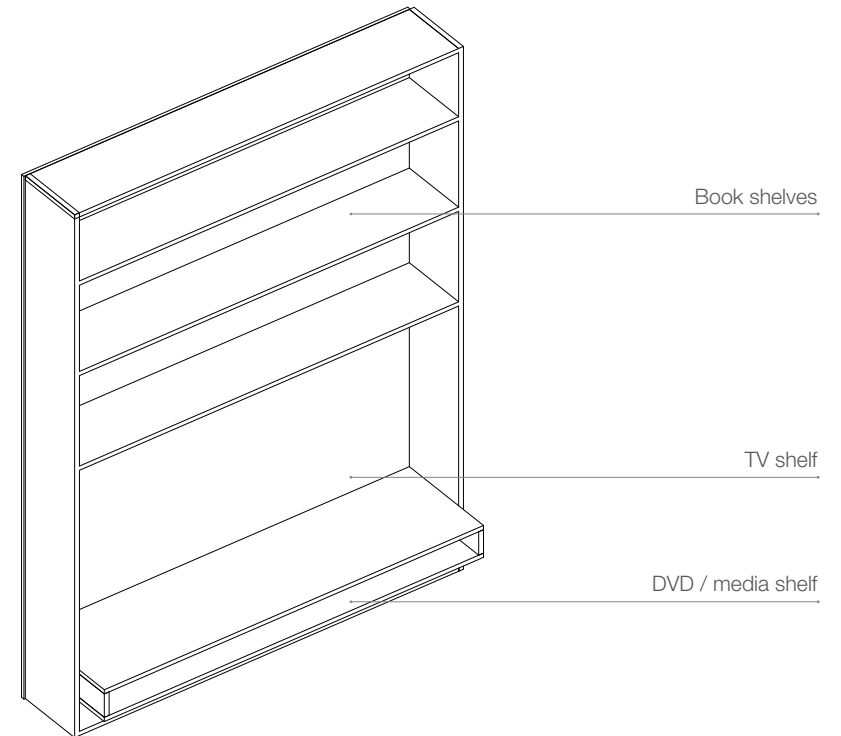

### How to Order

#### Step 01: Enquiry & Quote

Get in touch to discuss your project. We will ask you to provide us with basic measurements (alcove width, depth, height etc) and some photographs of the space. This will help us give you an accurate price for your item. We will also let you know current lead times (currently 3-4 weeks) and any other charges including delivery costs.

#### Step 02: Deposit

When happy with the initial design and quote, we will ask you for 10% non-refundable deposit.

#### Step 03: 3D Design

Based on your measurements, we will create a 3D design of your project. The drawings will show all key dimensions and any custom elements.

#### Step 04: Confirmation

Upon receiving your 3D design drawing, we will ask you to check the design and dimensions. We will happily work with you to make any changes until you are satisfied with the final design.

#### Step 05: Making

Once you are happy with the drawings, send us sign off and we will start making your piece.

#### Step 06: Delivery & Installation

Depending on the size and complexity of your project, we offer three delivery options:

- Collection and installation by client or your own builder
- Delivery by us, installation by client or your own builder
- Delivery and installation by us

If you choose to organise your own delivery or installation, we cannot take responsibility for any damage or issues that arise during the delivery or installation.

### What Else You Need to Know

#### Processing time:

3-4 weeks from placing your order.

#### Material:

Birch or Oak Veneer Plywood.

#### Fixing:

Screw fixing as appropriate to wall construction.

#### Finish:

Satin water-based varnish as standard or Osmo Hardwax Oil.

#### Customisation:

Please get in touch if you have any special requests.

#### Return:

Each piece is made especially for you and so cannot be returned - unless there is a fault of course.

**Note:** Colour tones and grain pattern vary from piece to piece due to the nature of the materials used.

### Get in Touch

[patrick@space-program.co.uk](mailto:patrick@space-program.co.uk)

+44 (0)7962 922664